

GATEWAY INDUSTRIAL

SW 27TH AVENUE

FOR

POMPANO BEACH, FL 33069

PARCEL ID NUMBER(S): 4942-04-09-0010

REFERENCES AND CONTACTS

◆ **ALTA LAND TITLE SURVEY**
BOHLER ENGINEERING FL, LLC
1900 NW CORPORATE BLVD,
SUITE 101E
BOCA RATON, FL 33431
PROJECT #: FLB210100

◆ **ARCHITECTURAL PLAN:**
DK ARCHITECTS
61 NE 1ST STREET, SUITE 2
POMPANO BEACH, FL 33060
PHONE: 954-941-3329
DATE: 6/11/2021

◆ **LANDSCAPE ARCHITECT:**
BRETT WALDMAN
1900 NW CORPORATE BLVD
SUITE 101E
BOCA RATON, FL 33431

GOVERNING AGENCIES

◆ **BROWARD COUNTY**
WATER & WASTEWATER ENGINEERING DIVISION
255 WEST COPANS RD
POMPANO BEACH, FL 33369
PHONE: (954) 831-0745

◆ **SFWMD**
3301 GUN CLUB ROAD
WEST PALM BEACH, FL 3340
PHONE: (561) 686-8800

◆ CITY OF POMPANO BEACH
100 WEST ATLANTIC BLVD.
POMPANO BEACH, FL 33360
PHONE: (954) 786-4600

UTILITIES

◆ **WATER/SEWER**
BROWARD COUNTY
WATER AND WASTEWATER SERVICES
HALINA PLUTA
PHONE: (954) 532-831-0917

◆ **CABLE**
COMCAST CABLE
RICHARD DAVIDSON
PHONE: (786) 586-8505

◆ TELEPHONE
AT&T
DINO FARUGGIO
PHONE: (561) 683-2729

◆ **GAS**
FLORIDA GAS TRANSMISSION - DAVENPORT
JOSEPH SANCHEZ
PHONE: (407) 838-7171

* THE ABOVE REFERENCED DOCUMENTS ARE INCORPORATED BY REFERENCE AS PART OF THESE PLANS, HOWEVER, BOHLER ENGINEERING DOES NOT CERTIFY THE ACCURACY OF THE WORK REFERENCED OR DERIVED FROM THESE DOCUMENTS, BY OTHERS.

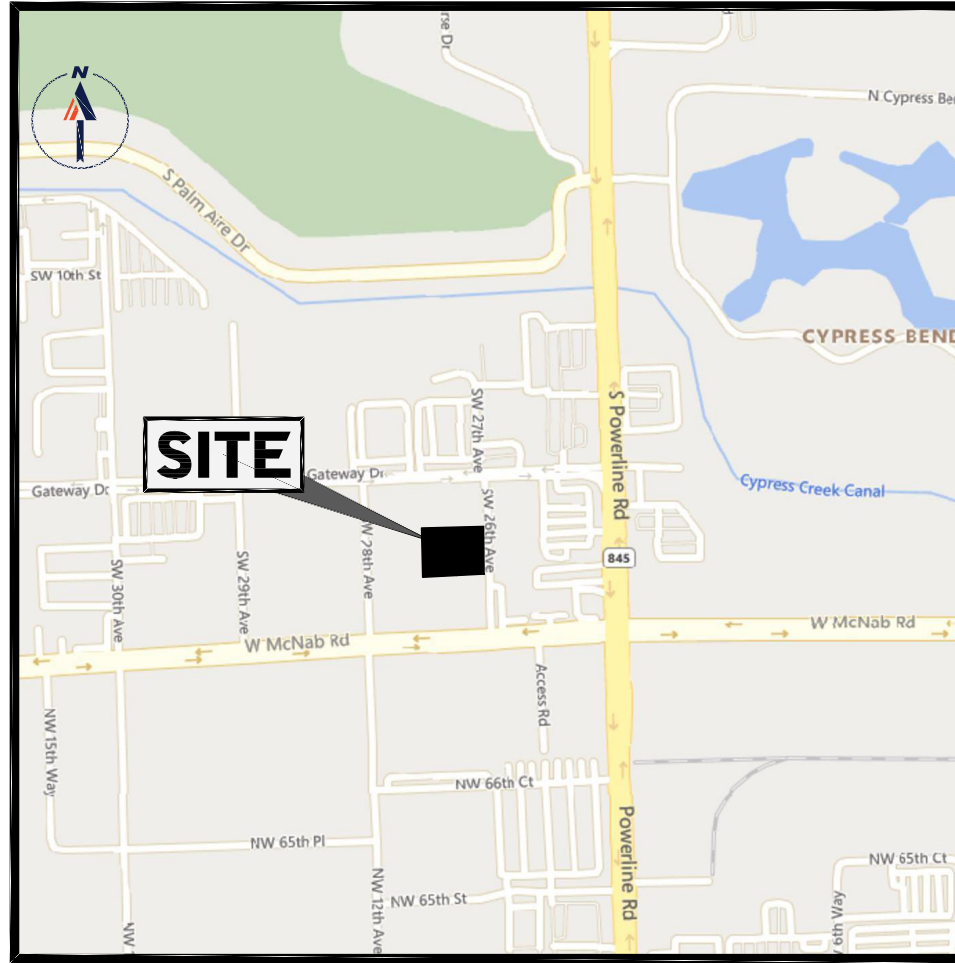
**LOCATION MAP**

SCALE: N.T.S

DEVELOPER/OWNER

IRA BERGSTEIN
ALLIANCE PARTNERS HSP, LLC
40 MORRIS AVENUE
SUITE 230
BRYN MAWR, PA 19010

PREPARED BY

BOHLER //

CONTACT: ROBERT MORGADO

RMORGADO@BOHLERENG.COM

<u>SHEET INDEX</u>	
SHEET TITLE	SHEET No.
COVER SHEET	C-101
GENERAL NOTES	C-102
GENERAL LEGENDS	C-103
SITE PLAN	C-301
TRUCK TURN PLAN	C-302
PEDESTRIAN ACCESS PLAN	C-303
PAVING, GRADING AND DRAINAGE PLAN	C-401
UTILITY PLAN	C-501
EROSION CONTROL PLAN	C-601
TREE DISPOSITION PLAN	C-701
TREE DISPOSITION NOTES	C-702
LANDSCAPE PLAN	C-703
LANDSCAPE DETAILS	C-704
LANDSCAPE NOTES	C-705
IRRIGATION PLAN	C-706
IRRIGATION DETAILS	C-707
IRRIGATION NOTES	C-708
LIGHTING PLAN	C-801
CONSTRUCTION DETAILS	C-901
CONSTRUCTION DETAILS	C-902
CONSTRUCTION DETAILS	C-903
CONSTRUCTION DETAILS	C-904
CONSTRUCTION DETAILS	C-905
CONSTRUCTION DETAILS	C-906

SHEET TITLE

COVER SHEET

SHEET NUMBER:

C-101

ORG. DATE - 02/21/2022

Dec 22, 2022
H:\2021\FB210118\CAD\DRAWINGS\PLAN SETS\FB210118 - CNDS - 0-----> LAYOUT: C-101 COVER SHEET